

# Huckleberry Layout

5 bedrooms; 22 beds; 26 maximum

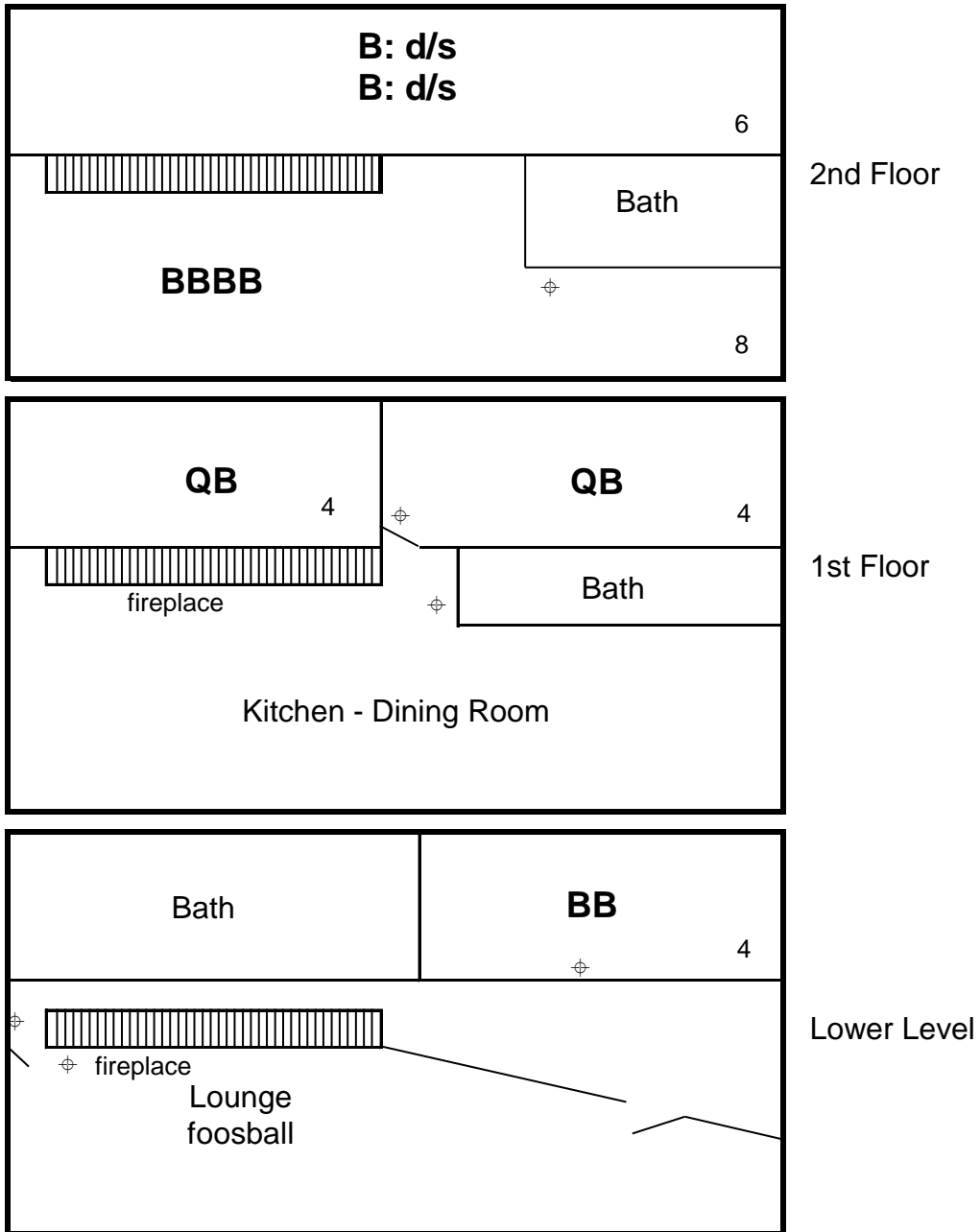

Q = Queen  
 B = Bunk (two singles)  
 B: d/s = Bunk (double lower, single upper)  
 ◊ Thermostat location  
 22 beds, accommodates 26  
 linens, towels, blankets & pillows not available for this facility



# Huckleberry Kitchen Inventory

\*You can expect to find this kitchen equipped to serve approximately 25 people with the items listed below.

\*Please wash and return items to their designated place after using them.

\*Report any damaged or missing items to the office.

---

## **APPLIANCES**

refrigerator  
kitchen range with oven  
microwave  
toaster  
(2) 12-cup coffee makers & filters

## **SILVERWARE**

knives  
forks  
spoons  
serving spoons

## **DINNERWARE**

dinner plates  
soup/salad bowls  
dessert plates  
cups  
mugs

## **BAKEWARE**

9" x 13" baking pans  
cookie sheets  
pizza pans  
casserole dishes (2 quart)  
roasting pan

## **COOKWARE**

2 assorted stock pots with lids  
2 assorted sauce pans with lids  
4 assorted frying pans

---

## **PREPARATION & SERVING EQUIPMENT**

ladles	box grater
large spoons	colander
wire whisks	liquid measuring cups
pancake turners	dry measuring cups
tongs	measuring spoons
meat forks	mixing bowls
rubber scrapers	assorted serving bowls
potato masher	assorted serving platters
meat thermometer	pitchers
ice cream scoops	
vegetable peelers	
pizza cutter	
assorted knives	

---

## **MISC. EQUIPMENT**

tea kettle	ice cube trays
cutting boards	sponges & Brillo pad
can opener	dish soap
salt & pepper shakers	
pot holders, dish cloths & dish towels	

---

## **ITEMS NOT PROVIDED**

salt, pepper, cooking spices or oils  
food, beverages, coffee or tea  
paper towels or napkins  
toiletries  
ice  
disposable plates, cups, or silverware  
aluminum foil, plastic wrap, etc.

**Please use the cans  
provided in this kitchen for  
your garbage and  
recyclables. THANK YOU!**